

Specifications

Model Number: 10-0115
Input Voltage: 230 VAC
Frequency: 45-65 Hz.
Lamp Type See Chart on Next Page
Certifications: CE
Size: 6.75" x 2.1" x 1.8" (170 x 55 x 45 mm)
Weight: 11.1 oz. (0.32 kg.)
Mounting: Slotted Mounting Tabs

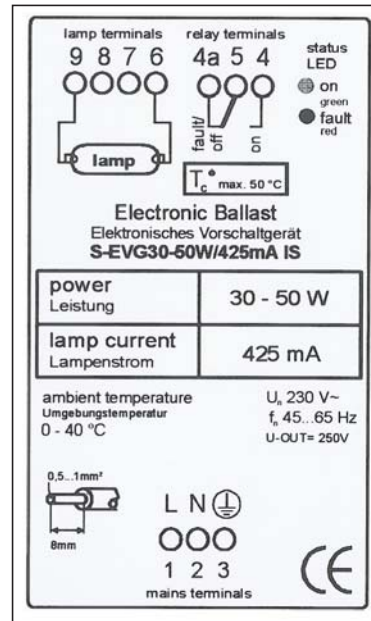
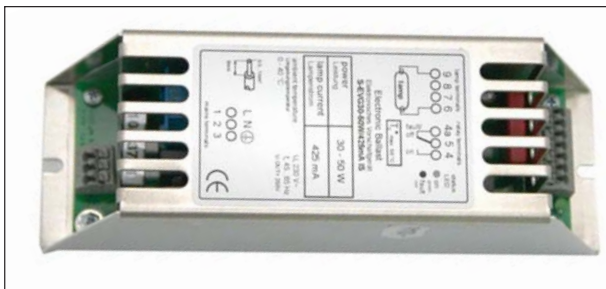

The information and recommendations contained in this publication are based upon data collected by the Atlantic Ultraviolet Corporation® and are believed to be correct. However, no guarantee or warranty of any kind, expressed or implied, is made with respect to the information contained herein. Specifications and information are subject to change without notice.

Lamp Types

Low Ozone Instant Start	Ozone Producing Instant Start
G30T5L	G30T5VH
G30T5L/U	G30T5VH/U
G36T5L	G36T5VH
G36T5L/U	G36T5VH/U
G37T5L	G37T5VH

This ballast may be acceptable for use with lamps not listed here. Contact us to discuss your requirement.

Connections

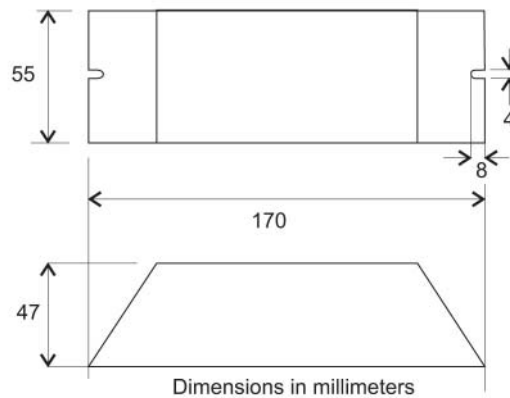
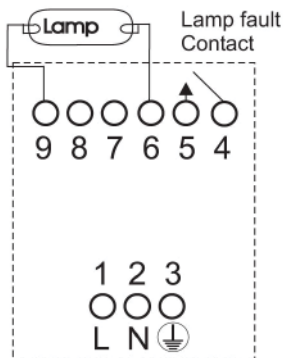

The information and recommendations contained in this publication are based upon data collected by the Atlantic Ultraviolet Corporation® and are believed to be correct. However, no guarantee or warranty of any kind, expressed or implied, is made with respect to the information contained herein. Specifications and information are subject to change without notice.