

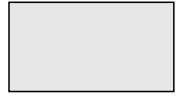

**F.LLI TASSALINI s.p.a.**

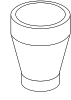



## RIDUZIONI

- Fabbricate in acciaio inossidabile AISI 304L e AISI 316L.
- Ricavate da tubi elettrouniti con sistema TIG, laminati a freddo e solubilizzati in atmosfera controllata.
- Calibrate internamente ed esternamente al fine di ottenere una buona circolarità.
- Intestate alle estremità per assicurare la perfetta ortogonalità dei piani.
- Tornite sulle parti cilindriche in accordo con le tolleranze dimensionali prescritte dalle principali norme internazionali; l'uniformità degli spessori permette la saldatura orbitale.
- Finitura standard: lucidatura esterna e satinatura interna grana 120 (max  $R_a$   $\mu\text{m}$  1,01-1,14; max  $R_a$   $\mu''$  40-45) norme DIN; satinatura esterna e interna grana 120 norme SMS, BS, ISS; lucidatura esterna e interna grana 150 (max  $R_a$   $\mu\text{m}$  0,76-0,89; max  $R_a$   $\mu''$  30-35) norme Clamp. A richiesta, lucidatura esterna e interna grana 240 (max  $R_a$   $\mu\text{m}$  0,38-0,51; max  $R_a$   $\mu''$  15-20), lucidatura elettrolitica grana 400 (max  $R_a$   $\mu\text{m}$   $\leq$  0,2; max  $R_a$   $\mu''$   $\leq$  8).
- Produzione standard: riduzioni concentriche ed eccentriche, riduzioni con estremità semiraccordo. A richiesta, disponibili corredate di raccordi DIN, SMS, BS e ISS mandrinati o saldati.

## REDUCERS

- Made of AISI 304L and AISI 316L stainless steel.
- Made from pipe electrojointed with the TIG method, cold-rolled and solution heat-treated in controlled atmosphere.
- Gauged inside and outside to obtain suitable roundness.
- Faced on the ends to ensure perfect right angles of planes.
- Turned on the cylindrical parts in conformity with dimensional tolerance levels stipulated by the main international standards. Uniform wall thickness allows for orbital welding.
- Standard finish: 120 grain external polishing and internal glazing (max  $R_a$   $\mu\text{m}$  1.01-1.14; max  $R_a$   $\mu''$  40-45) to DIN standards; 120 grain external and internal glazing to SMS, BS and ISS standards; 150 grain external and internal polishing (max  $R_a$   $\mu\text{m}$  0.76-0.89; max  $R_a$   $\mu''$  30-35) to Clamp standards. On request 240 grain external and internal polishing (max  $R_a$   $\mu\text{m}$  0.38-0.51; max  $R_a$   $\mu''$  15-20); 400 grain electrolytic polishing (max  $R_a$   $\mu\text{m}$   $\leq$  0.2; max  $R_a$   $\mu''$   $\leq$  8).
- Standard production: concentric and eccentric reducers; reducers with end ferrule. On request available with expanded or welded DIN, SMS, BS, ISS unions.

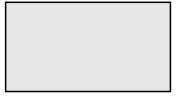

## RÉDUCTIONS

- Fabriquées en acier inoxydable AISI 304L et AISI 316L.
- Obtenues à partir de tubes électrosoudés avec le système TIG, laminés à froid et solubilisés en atmosphère contrôlée.
- Calibrées à l'intérieur et à l'extérieur afin d'obtenir une bonne circularité.
- Façonnées aux extrémités pour assurer l'orthogonalité parfaite des plans.
- Usinées sur les parties cylindriques en respectant les tolérances dimensionnelles imposées par les principales normes internationales; l'uniformité des épaisseurs permet la soudure orbitale.
- Finissage standard: polissage extérieur et satinage intérieur grain 120 (max  $R_a$   $\mu\text{m}$  1,01-1,14; max  $R_a$   $\mu''$  40-45) normes DIN; satinage extérieur et intérieur grain 120 normes SMS, BS, ISS; polissage extérieur et intérieur grain 150 (max  $R_a$   $\mu\text{m}$  0,76-0,89; max  $R_a$   $\mu''$  30-35) normes Clamp. Sur demande, polissage extérieur et intérieur grain 240 (max  $R_a$   $\mu\text{m}$  0,38-0,51; max  $R_a$   $\mu''$  15-20), polissage électrolytique grain 400 (max  $R_a$   $\mu\text{m}$   $\leq$  0,2; max  $R_a$   $\mu''$   $\leq$  8).
- Production standard: réductions concentriques et excentriques, réductions avec bout ferrule. Sur demande, munies de raccords DIN, SMS, BS, ISS dudgeonnés ou soudés.

## REDUCCIONES

- Fabricadas de acero inoxidable AISI 304L y AISI 316L.
- Obtenidas a partir de tubos unidos eléctricamente mediante el sistema TIG, laminados en frío y solubilizados en atmósfera controlada.
- Calibradas interior y exteriormente con la finalidad de obtener una forma circular perfecta.
- Trabajadas en los extremos para asegurar que las superficies sean perfectamente ortogonales.
- Torneadas en las partes cilíndricas de acuerdo a las tolerancias de las dimensiones prescritas por las principales normas internacionales; el espesor de pared uniforme permite la soldadura orbital.
- Acabado estándar: pulido exterior y satinado interior grano 120 (max  $R_a$   $\mu\text{m}$  1,01-1,14; max  $R_a$   $\mu''$  40-45) normas DIN; satinado exterior e interior grano 120 normas SMS, BS, ISS; pulido exterior e interior grano 150 (max  $R_a$   $\mu\text{m}$  0,76-0,89; max  $R_a$   $\mu''$  30-35) normas Clamp. A pedido, pulido exterior e interior grano 240 (max  $R_a$   $\mu\text{m}$  0,38-0,51; max  $R_a$   $\mu''$  15-20), pulido electrolítico grano 400 (max  $R_a$   $\mu\text{m}$   $\leq$  0,2; max  $R_a$   $\mu''$   $\leq$  8).
- Producción estándar: reducciones concéntricas y excéntricas, reducciones con extremo semiracor. A pedido, se pueden suministrar con racores DIN, SMS, BS, ISS mandrilados o soldados.



RIDUZIONI  
REDUCERS  
RÉDUCTIONS  
REDUCCIONES

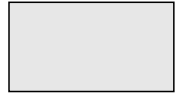

RIDUZIONE CONC. SR.  
WG. CONC. REDUCER  
RÉDUCTION CONC. SR.  
REDUCCIÓN CONC. SR.

169 L

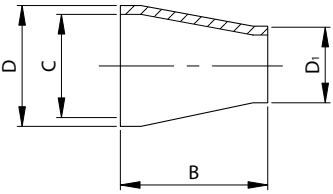

DN	B	C	D	D <sub>1</sub>	gr
18/12	38,0	15,5	18,0	12,0	30
22/12	38,0	19,5	22,0	12,0	40
22/18	38,0	19,5	22,0	18,0	40
28/12	38,0	25,0	28,0	12,0	50
28/18	38,0	25,0	28,0	18,0	50
28/22	38,0	25,0	28,0	22,0	50
34/28	67,0	31,0	34,0	28,0	60
40/28	67,0	37,0	40,0	28,0	60
40/34	67,0	37,0	40,0	34,0	60
52/28	67,0	49,0	52,0	28,0	100
52/34	67,0	49,0	52,0	34,0	100
52/40	67,0	49,0	52,0	40,0	110
70/40	67,0	66,0	70,0	40,0	120
70/52	67,0	66,0	70,0	52,0	160
85/40	88,0	81,0	85,0	40,0	180
85/52	67,0	81,0	85,0	52,0	190
85/70	67,0	81,0	85,0	70,0	240
101/52	105,0	97,6	101,6	52,0	300
101/70	72,0	97,6	101,6	70,0	290
101/85	67,0	97,6	101,6	85,0	280
104/52	107,0	100,0	104,0	52,0	300
104/70	72,0	100,0	104,0	70,0	290
104/85	67,0	100,0	104,0	85,0	280

RIDUZIONE CONC. EL.  
CONC. REDUCER PE.  
RÉDUCTION CONC. BL.  
REDUCCIÓN CONC. EL.

170 L

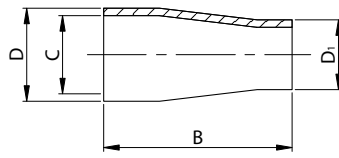

DN	B	C	D	D <sub>1</sub>	gr
18/12	67,0	15,5	18,0	12,0	30
22/12	67,0	19,5	22,0	12,0	40
22/18	67,0	19,5	22,0	18,0	40
28/12	67,0	25,0	28,0	12,0	50
28/18	67,0	25,0	28,0	18,0	50
28/22	67,0	25,0	28,0	22,0	50
34/12	67,0	31,0	34,0	12,0	80
34/18	67,0	31,0	34,0	18,0	80
34/22	98,0	31,0	34,0	22,0	90
34/28	88,0	31,0	34,0	28,0	90
40/12	67,0	37,0	40,0	12,0	100
40/18	67,0	37,0	40,0	18,0	110
40/22	105,0	37,0	40,0	22,0	110
40/28	98,0	37,0	40,0	28,0	120
40/34	88,0	37,0	40,0	34,0	120
52/28	134,0	49,0	52,0	28,0	155
52/34	105,0	49,0	52,0	34,0	210
52/40	98,0	49,0	52,0	40,0	180
70/34	120,0	66,0	70,0	34,0	220
70/40	120,0	66,0	70,0	40,0	220
70/52	105,0	66,0	70,0	52,0	270
85/40	147,0	81,0	85,0	40,0	440
85/52	125,0	81,0	85,0	52,0	430
85/70	105,0	81,0	85,0	70,0	500
101/52	155,0	97,6	101,6	52,0	560
101/70	127,0	97,6	101,6	70,0	550
101/85	120,0	97,6	101,6	85,0	550
104/52	165,0	100,0	104,0	52,0	530
104/70	127,0	100,0	104,0	70,0	525
104/85	120,0	100,0	104,0	85,0	550

RIDUZIONE ECC. SR.  
WG. ECC. REDUCER  
RÉDUCTION EXC. SR.  
REDUCCIÓN EXC. SR.

179 L

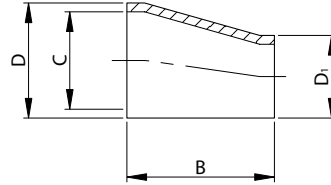

DN	B	C	D	D <sub>1</sub>	gr
34/28	67,0	31,0	34,0	28,0	60
40/28	67,0	37,0	40,0	28,0	60
40/34	67,0	37,0	40,0	34,0	60
52/28	68,0	49,0	52,0	28,0	100
52/34	67,0	49,0	52,0	34,0	100
52/40	67,0	49,0	52,0	40,0	110
70/40	71,0	66,0	70,0	40,0	120
70/52	67,0	66,0	70,0	52,0	160
85/52	79,0	81,0	85,0	52,0	190
85/70	67,0	81,0	85,0	70,0	240
101/52	110,0	97,6	101,6	52,0	300
101/70	67,0	97,6	101,6	70,0	290
101/85	67,0	97,6	101,6	85,0	280
104/52	110,0	100,0	104,0	52,0	300
104/70	67,0	100,0	104,0	70,0	290
104/85	67,0	100,0	104,0	85,0	280

RIDUZIONE ECC. EL.  
ECC. REDUCER PE.  
RÉDUCTION EXC. BL.  
REDUCCIÓN EXC. EL.

180 L

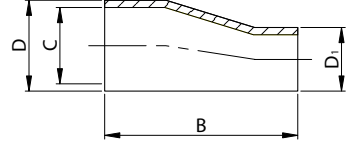

DN	B	C	D	D <sub>1</sub>	gr
34/28	102,0	31,0	34,0	28,0	60
40/28	110,0	37,0	40,0	28,0	60
40/34	102,0	37,0	40,0	34,0	60
52/28	130,0	49,0	52,0	28,0	100
52/34	120,0	49,0	52,0	34,0	100
52/40	110,0	49,0	52,0	40,0	110
70/40	153,0	66,0	70,0	40,0	120
70/52	130,0	66,0	70,0	52,0	160
85/52	146,0	81,0	85,0	52,0	190
85/70	120,0	81,0	85,0	70,0	240
101/52	150,0	97,6	101,6	52,0	300
101/70	153,0	97,6	101,6	70,0	290
101/85	118,0	97,6	101,6	85,0	280
104/52	148,0	100,0	104,0	52,0	300
104/70	153,0	100,0	104,0	70,0	290
104/85	118,0	100,0	104,0	85,0	280

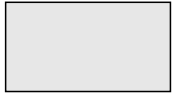

RIDUZIONE CONC. SR.  
WG. CONC. REDUCER  
RÉDUCTION CONC. SR.  
REDUCCIÓN CONC. SR.

169 L

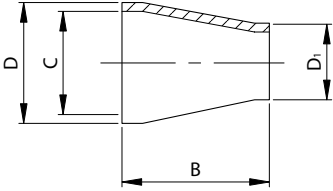

DN	B	C	D	D <sub>1</sub>	gr
38/25	67,0	35,1	38,1	25,4	80
51/25	67,0	47,8	50,8	25,4	100
51/38	67,0	47,8	50,8	38,1	100
63/38	67,0	60,2	63,5	38,1	140
63/51	67,0	60,2	63,5	50,8	160
76/38	67,0	72,9	76,2	38,1	160
76/51	67,0	72,9	76,2	50,8	180
76/63	67,0	72,9	76,2	63,5	220
101/51	107,0	97,6	101,6	50,8	310
101/63	82,0	97,6	101,6	63,5	300
101/76	67,0	97,6	101,6	76,2	280
104/51	109,0	100,0	104,0	50,8	310
104/63	89,0	100,0	104,0	63,5	300
104/76	67,0	100,0	104,0	76,2	280

RIDUZIONE CONC. EL.  
CONC. REDUCER PE.  
RÉDUCTION CONC. BL.  
REDUCCIÓN CONC. EL.

170 L

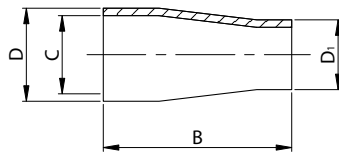

DN	B	C	D	D <sub>1</sub>	gr
38/25	97,0	35,1	38,1	25,4	110
51/25	115,0	47,8	50,8	25,4	170
51/38	97,0	47,8	50,8	38,1	150
63/38	115,0	60,2	63,5	38,1	230
63/51	97,0	60,2	63,5	50,8	190
76/38	132,0	72,9	76,2	38,1	300
76/51	115,0	72,9	76,2	50,8	260
76/63	97,0	72,9	76,2	63,5	240
101/51	145,0	97,6	101,6	50,8	590
101/63	120,0	97,6	101,6	63,5	580
101/76	120,0	97,6	101,6	76,2	580
104/51	155,0	100,0	104,0	50,8	600
104/63	140,0	100,0	104,0	63,5	590
104/76	127,0	100,0	104,0	76,2	590

RIDUZIONE ECC. SR.  
WG. ECC. REDUCER  
RÉDUCTION EXC. SR.  
REDUCCIÓN EXC. SR.

179 L

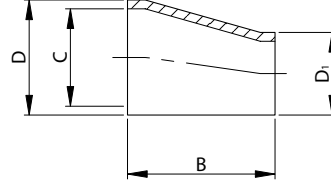

DN	B	C	D	D <sub>1</sub>	gr
38/25	67,0	35,1	38,1	25,4	80
51/25	73,0	47,8	50,8	25,4	100
51/38	67,0	47,8	50,8	38,1	100
63/38	71,0	60,2	63,5	38,1	140
63/51	67,0	60,2	63,5	50,8	160
76/38	80,0	72,9	76,2	38,1	160
76/51	67,0	72,9	76,2	50,8	180
76/63	67,0	72,9	76,2	63,5	220
101/51	110,0	97,6	101,6	50,8	310
101/63	88,0	97,6	101,6	63,5	300
101/76	67,0	97,6	101,6	76,2	280
104/51	115,0	100,0	104,0	50,8	310
104/63	88,0	100,0	104,0	63,5	300
104/76	67,0	100,0	104,0	76,2	280

RIDUZIONE ECC. EL.  
ECC. REDUCER PE.  
RÉDUCTION EXC. BL.  
REDUCCIÓN EXC. EL.

180 L

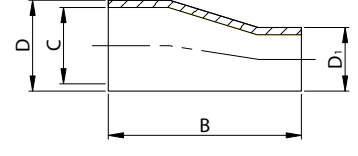

DN	B	C	D	D <sub>1</sub>	gr
38/25	104,0	35,1	38,1	25,4	80
51/25	120,0	47,8	50,8	25,4	100
51/38	105,0	47,8	50,8	38,1	100
63/38	130,0	60,2	63,5	38,1	140
63/51	103,0	60,2	63,5	50,8	160
76/38	139,0	72,9	76,2	38,1	160
76/51	126,0	72,9	76,2	50,8	180
76/63	105,0	72,9	76,2	63,5	220
101/51	150,0	97,6	101,6	50,8	310
101/63	143,0	97,6	101,6	63,5	300
101/76	128,0	97,6	101,6	76,2	280
104/51	148,0	100,0	104,0	50,8	310
104/63	145,0	100,0	104,0	63,5	300
104/76	128,0	100,0	104,0	76,2	280

RIDUZIONE CONC. EL.  
CONC. REDUCER PE.  
REDUCTION CONC. BL.  
REDUCCIÓN CONC. EL.

W31

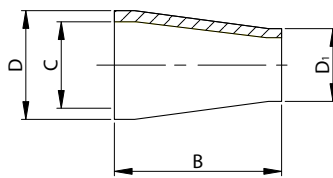

DN	B	C	D	D <sub>1</sub>	gr
19/12	25,4	15,7	19,0	12,7	50
25/12	25,4	22,1	25,4	12,7	70
25/19	25,4	22,1	25,4	19,0	80
38/12	50,8	34,8	38,1	12,7	90
38/19	50,8	34,8	38,1	19,0	90
38/25	67,0	34,8	38,1	25,4	100
51/38	67,0	47,5	50,8	38,1	140
63/51	67,0	60,2	63,5	50,8	160
76/51	67,0	72,9	76,2	50,8	180
76/63	67,0	72,9	76,2	63,5	220
101/76	67,0	97,4	101,6	76,2	280

RIDUZIONE CONC. E. SM.  
CONC. REDUCER E. FR.  
REDUCTION CONC. B. FR.  
REDUCCIÓN CONC. E. SM.

K31

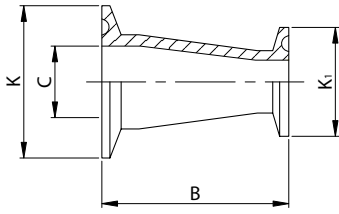

DN	B	C	K	K <sub>1</sub>	gr
19/12	50,8	15,7	25,0	25,0	80
25/12	50,8	22,1	50,5	25,0	140
25/19	50,8	22,1	50,5	25,0	160
38/12	76,2	34,8	50,5	25,0	200
38/19	76,2	34,8	50,5	25,0	200
38/25	92,4	34,8	50,5	50,5	240
51/38	92,4	47,5	64,0	50,5	250
63/51	92,4	60,2	77,5	64,0	300
76/51	92,4	72,9	91,0	64,0	400
76/63	92,4	72,9	91,0	77,5	390
101/76	95,5	97,4	119,0	91,0	775

RIDUZIONE ECC. EL.  
ECC. REDUCER PE.  
REDUCTION EXC. BL.  
REDUCCIÓN EXC. EL.

W32

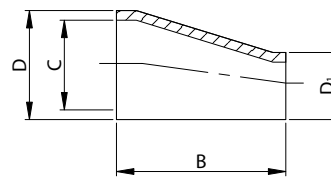

DN	B	C	D	D <sub>1</sub>	gr
19/12	25,4	15,7	19,0	12,7	50
25/12	25,4	22,1	25,4	12,7	80
25/19	25,4	22,1	25,4	19,0	80
38/25	67,0	34,8	38,1	25,4	110
51/38	67,0	47,5	50,8	38,1	150
63/51	67,0	60,2	63,5	50,8	170
76/51	67,0	72,9	76,2	50,8	250
76/63	67,0	72,9	76,2	63,5	230
101/76	67,0	97,4	101,6	76,2	510

RIDUZIONE ECC. E. SM.  
ECC. REDUCER E. FR.  
REDUCTION EXC. B. FR.  
REDUCCIÓN EXC. E. SM.

K32

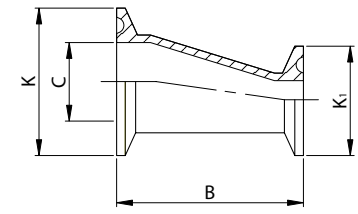

DN	B	C	K	K <sub>1</sub>	gr
19/12	50,8	15,7	25,0	25,0	80
25/12	50,8	22,1	50,5	25,0	160
25/19	50,8	22,1	50,5	25,0	160
38/25	92,4	34,8	50,5	50,5	250
51/38	92,4	47,5	64,0	50,5	260
63/51	92,4	60,2	77,5	64,0	300
76/51	92,4	72,9	91,0	64,0	400
76/63	92,4	72,9	91,0	77,5	400
101/76	95,5	97,4	119,0	91,0	790

**F.LLI TASSALINI OFFICINA MECCANICA S.P.A.**  
**Via G. Di Vittorio 19/21 - 20068 Peschiera Borromeo (MI) - Italy**  
**Tel. (+39) 02 55 38 311 - Fax (+39) 02 54 73 441**  
**[www.tassalini.com](http://www.tassalini.com)**  
**[info@tassalini.it](mailto:info@tassalini.it)**