

Seismic Flex Loops

Unisource Series 430 Beveled Weld End "V-Loop"

Series 430 loops are configured with carbon steel schedule 40 beveled weld ends as standard.

As in other configurations of **V-Loops**, choose from either 2" or 4" of motion from center-line. For steam service, Unisource recommends placing the loops in either an inverted or horizontal installation when conveying steam. A drain port should also be specified for steam service. Unisource can also add an eyelet at the 90 degree elbow to accommodate a support rod or cable.

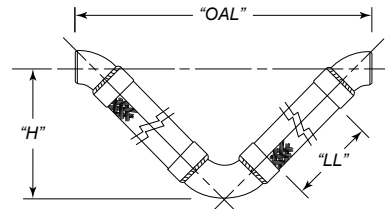
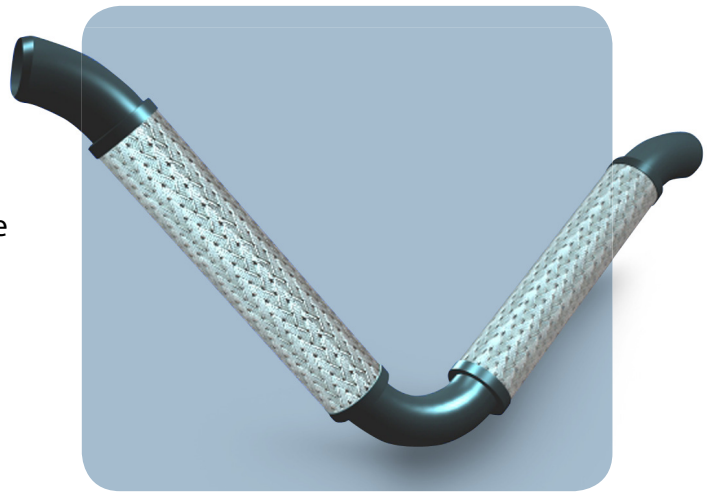

SERIES 430 WELD-END "V-LOOP"

Hose: Type 321 S/S

Braid: Type 304 S/S

Elbows: Carbon Steel, Sch 40

Ends: Carbon Steel, Sch 40, Beveled Weld End

Part #	Size (Inches)	Overall Length OAL (Inches)	Live Length LL (Inches)	Height H (Inches)	Approximate Spring Force (Lbs.) to Deflect the Full Rated Movement	Pressure Ratings (PSIG)		Allowable Motions X, Y, or Z
						W.P.	Max. Test	
430-200-2	2	30-7/8	14	14	40	516	774	2"
430-250-2	2-1/2	34-5/8	14-1/2	15-1/2	114	387	581	
430-300-2	3	39-3/8	16-1/2	17-1/2	137	316	474	
430-400-2	4	44-1/2	18	19-1/2	152	232	348	
430-500-2	5	52-3/8	20	22-3/4	395	191	286	
430-600-2	6	58-3/4	21-1/2	25-1/4	608	165	247	
430-800-2	8	70-7/8	24	29-3/4	1671	234	350	
430-1000-2	10	83-1/2	27	34-3/4	2127	230	344	
430-1200-2	12	94-1/4	28-1/2	38-1/2	2340	161	241	

430-200-4	2	39-3/8	20	18-1/4	40	516	774	4"
430-250-4	2-1/2	43	20-1/2	19-5/8	114	387	581	
430-300-4	3	49-1/2	23-1/2	22-1/2	137	316	474	
430-400-4	4	55-1/4	25-1/2	24-7/8	152	232	348	
430-500-4	5	64-1/2	28-1/2	28-3/4	395	191	286	
430-600-4	6	71-1/2	30-1/2	31-1/2	608	165	247	
430-800-4	8	85	34	36-7/8	1671	234	350	
430-1000-4	10	99-7/8	38-1/2	42-7/8	2127	230	344	
430-1200-4	12	103	41	47-3/8	2340	161	241	

* Total force necessary to accommodate full 2" motion, calculated @ 100 PSIG except 2-1/2" - 4" @ 150 PSI. Note: 1) Maximum operating temperature: 800° F.