

HALLOWELL GUARDRAIL INSTALLATION DETAILS

General Instructions

1. Check material received against the packing list. Check the number of packages received and then check the contents of each package.
2. Check the material received for damage. If damage has occurred, secure a “damage notation” from the carrier
3. Identify each part as it is unpacked and put like parts together as close as possible to the working area where they are to be assembled.
4. Be careful to use the correct hardware as specified in the assembly instructions.

CAUTION

In the interest of safety, all lockers must be securely anchored to the floor and/or wall. For safety, handle all components carefully and wear work gloves when assembling lockers. Install all units plumb and tighten all hardware securely. Retain instructions for future reference.



866-566-0500
info@Hallowell-List.com
www.Hallowell-List.com



GUARDRAIL FLOOR ANCHORING INSTRUCTIONS

Hardware Needed:

- 5/8" X 4" Self Threading Anchor for Concrete
- 1/2" Carbide Drill Bit
- Wrench or Impact Wrench

Installation Steps for Concrete, Lightweight Concrete and Metal Deck:

1. Using the 1/2" carbide drill bit, drill a hole at least 1" deeper than anchor embedment.
2. Using an impact wrench or manual socket wrench, insert anchor into hole and tighten anchor until fully seated. If installation torque exceeds 50 ft. lbs. using an impact wrench, remove anchor from hole. Reinstall with a new anchor using a manual socket wrench.

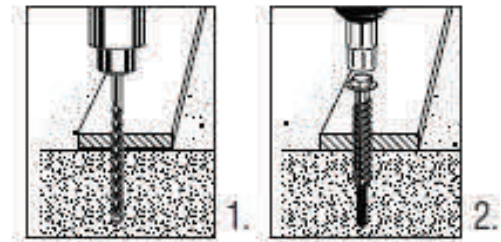

Caution:

Observe torque values particularly when installing anchor in higher compressive strength concrete with an impact wrench. Over-torquing may result in lower tension and/or shear performance of the anchor.

Use of core drills is not recommended to drill holes with this anchor.

Not recommended with use in new concrete which has not had sufficient time to cure.

Carbide drill bits are recommended for the installation of this anchor.

NOTES:
 1) USE PHC100 AT ALL UNUSED LOCATIONS

ITEM NO.	PART NUMBER	DESCRIPTION	QTY.
1	CS-1	18IN STANDARD COLUMN	1
2	GR-xx	GUARD RAIL SECTION	1
3	CS103	1/2-13 X 1-1/4 GRADE 5 HEX CAP SCREW	4
4	LDT100	5/8 X 4 LDT SELF THREADING ANCHOR	4
5	PHC100	PLASTIC HOLE COVER	6

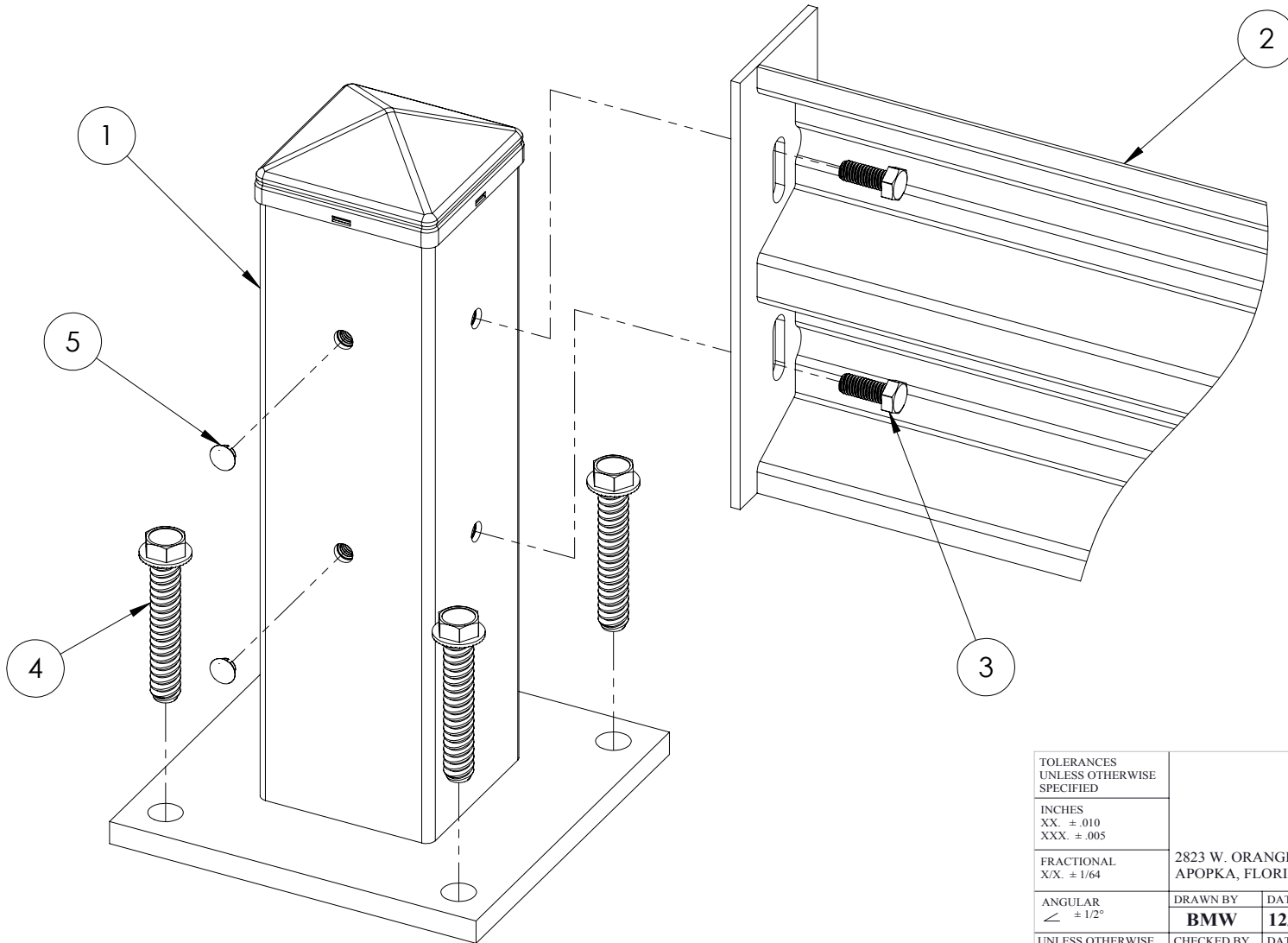

TOLERANCES
UNLESS OTHERWISE
SPECIFIED

INCHES
XX. ± .010
XXX. ± .005

FRACTIONAL
X/X. ± 1/64

ANGULAR
∠ ± 1/2°

UNLESS OTHERWISE
SPECIFIED ALL
DIMENSIONS ARE IN
INCHES. METRIC
DIMENSIONS WILL BE
WITHIN [XX]



www.Hallowell-List.com

2823 W. ORANGE AVE.
APOPKA, FLORIDA 32703

Tel (866) 566-0500
Fax (407) 464-3610

DRAWN BY	DATE	DESCRIPTION				
BMW	12/6/2012		CS-1 CONNECTION DETAIL			
CHECKED BY	DATE					
APPROVED BY	DATE	SCALE	SHEET	PART NO.	DRAWING NO.	REV.
			1 OF 1		SA-1559	

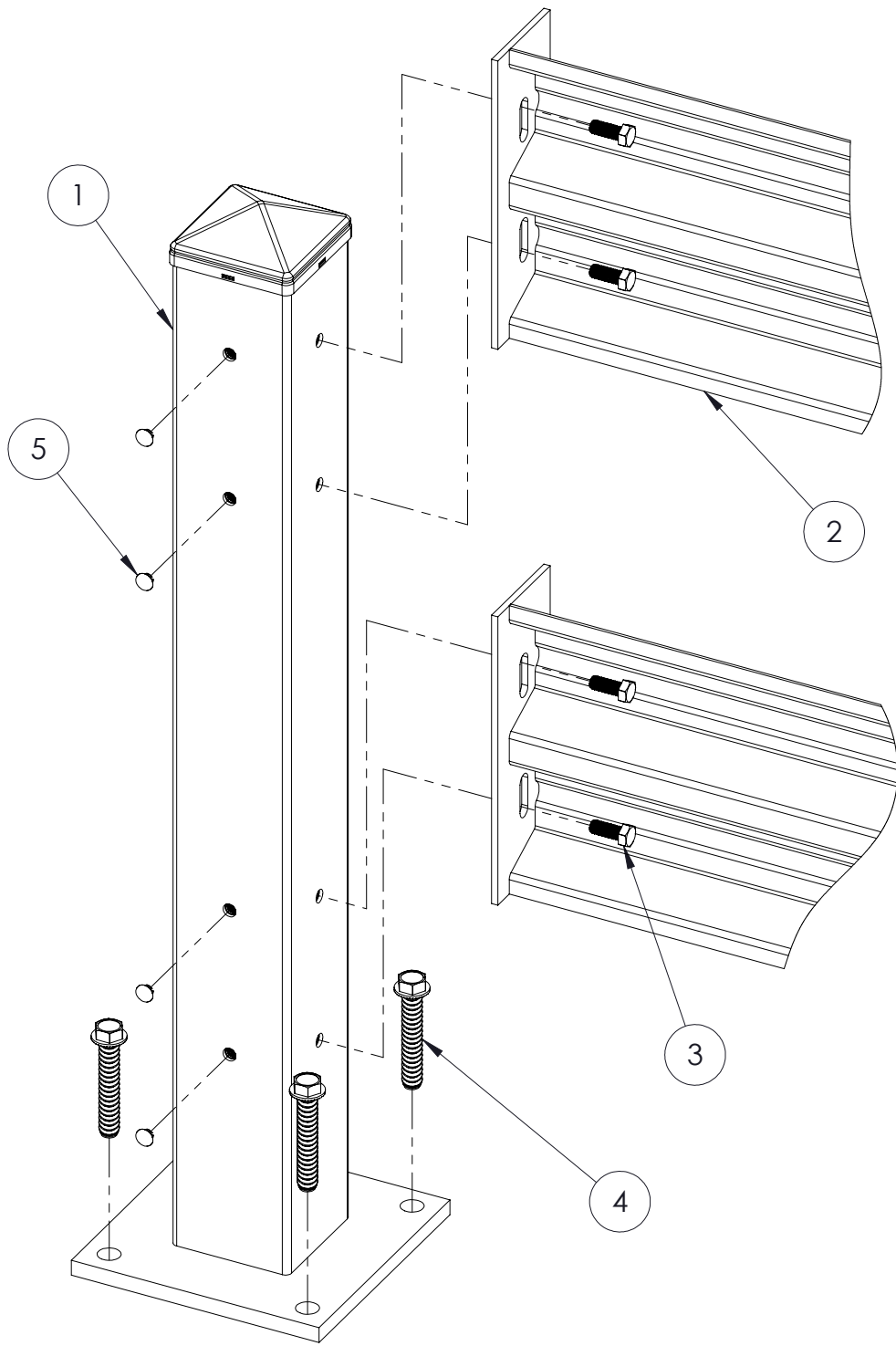

ITEM NO.	PART NUMBER	DESCRIPTION	QTY.
1	CS-2	42IN STANDARD COLUMN	1
2	GR-xx	GUARD RAIL SECTION	2
3	CS103	1/2-13 X 1-1/4 GRADE 5 HEX CAP SCREW	8
4	LDT100	5/8 X 4 LDT SELF THREADING ANCHOR	4
5	PHC100	PLASTIC HOLE COVER	12

NOTES:

1) USE PHC100 AT ALL UNUSED LOCATIONS

THIS DRAWING AND THE INFORMATION ON IT IS THE CONFIDENTIAL PROPERTY OF HALLOWELL, AND SHALL NOT BE COPIED OR DISCLOSED TO OTHERS WITHOUT WRITTEN PERMISSION. ONLY HALLOWELL RESERVES THE RIGHT TO ALTER ANY DESIGN. ANY UNAUTHORIZED MODIFICATIONS RELEASES HALLOWELL FROM ALL LIABILITIES.

TOLERANCES
UNLESS OTHERWISE
SPECIFIED

INCHES
XX. ± .010
XXX. ± .005

FRACTIONAL
X/X. ± 1/64

ANGULAR
∠ ± 1/2°

UNLESS OTHERWISE
SPECIFIED ALL
DIMENSIONS ARE IN
INCHES. METRIC
DIMENSIONS WILL BE
WITHIN [XX]

Hallowell

www.Hallowell-List.com

2823 W. ORANGE AVE.
APOPKA, FLORIDA 32703

Tel (866) 566-0500
Fax (407) 464-3610

DRAWN BY **BMW** DATE **12/10/2012**

CHECKED BY DATE

APPROVED BY DATE

DESCRIPTION		SCALE	SHEET	PART NO.	DRAWING NO.	REV.
CS-2 CONNECTION DETAIL			1 of 1		SA-1560	

NOTES:
1. USE PHC100 AT ALL UNUSED LOCATIONS

ITEM NO.	PART NUMBER	DESCRIPTION	QTY.
1	CS-1	18IN STANDARD COLUMN	1
2	GR-xx	GUARD RAIL SECTION	1
3	CS103	1/2 X 1-1/4 GRADE 5 EX CAP SCREW	4
4	LDT100	5/8 X 4 LDT SELF THREADING ANCHOR	4
5	PHC100	PLASTIC HOLE COVER	6
6	LOA	LIFT OUT ADAPTER	1
7	45-BRACKET	ANGLE BRACKET	--

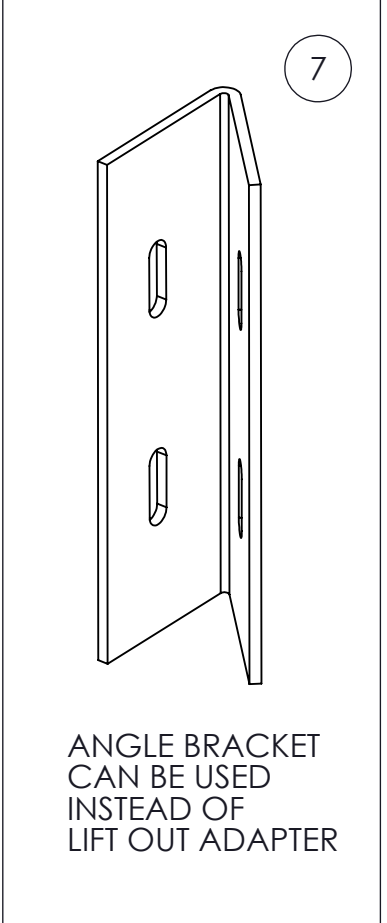
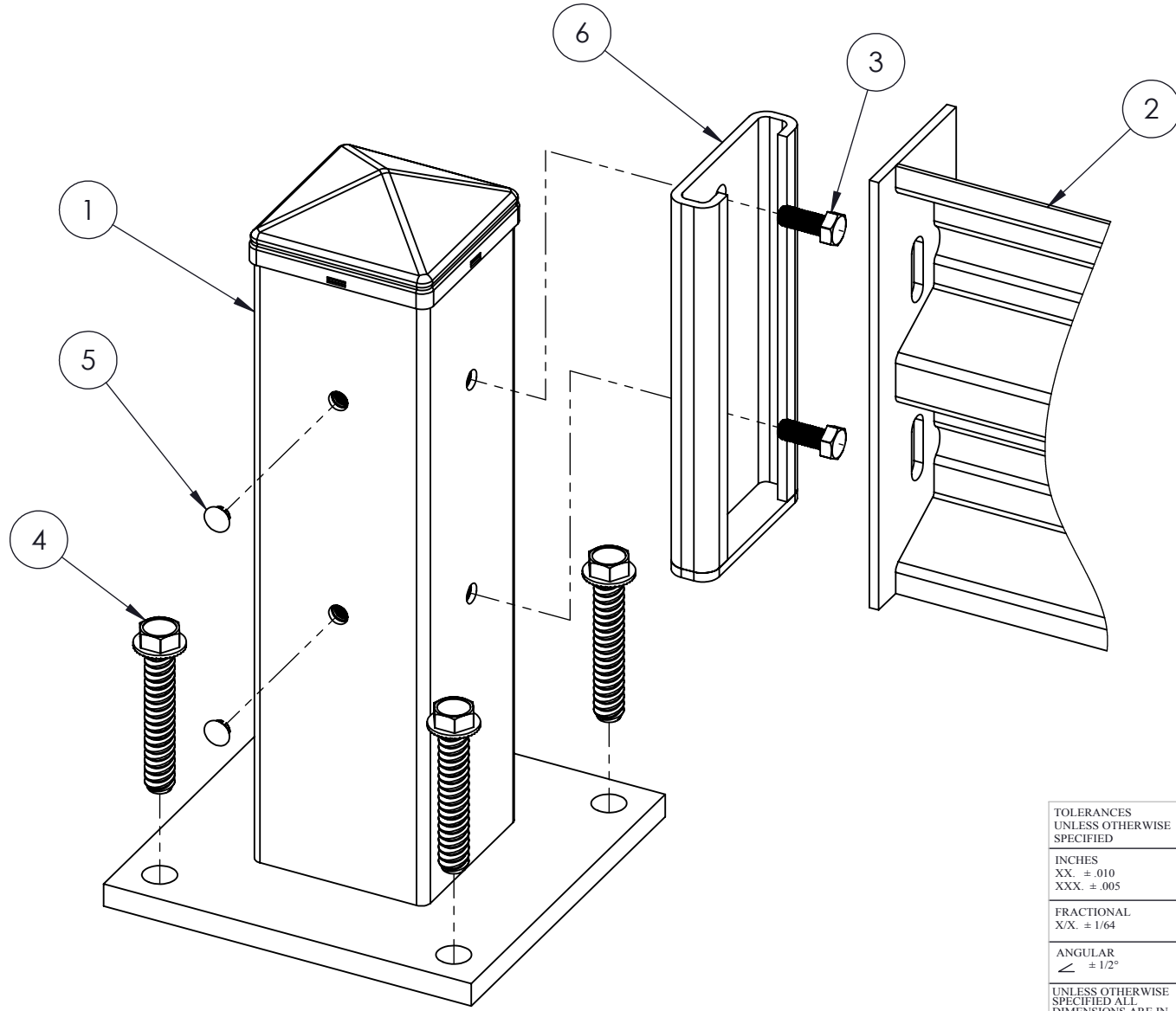

THIS DRAWING AND THE INFORMATION ON IT IS THE CONFIDENTIAL PROPERTY OF HALLOWELL, AND SHALL NOT BE COPIED OR DISCLOSED TO OTHERS WITHOUT WRITTEN PERMISSION. ONLY HALLOWELL RESERVES THE RIGHT TO ALTER ANY DESIGN. ANY UNAUTHORIZED MODIFICATIONS RELEASES HALLOWELL FROM ALL LIABILITIES.

TOLERANCES UNLESS OTHERWISE SPECIFIED		 www.Hallowell-List.com		2823 W. ORANGE AVE.		Tel (866) 566-0500		
INCHES XX. ± .010 XXX. ± .005				APOPKA, FLORIDA 32703		Fax (407) 464-3610		
FRACTIONAL X/X. ± 1/64		DRAWN BY	DATE	DESCRIPTION				
ANGULAR ∠ ± 1/2°		JIL	7/18/2013	LIFT OUT ADAPTER & ANGLE BRACKET				
UNLESS OTHERWISE SPECIFIED ALL DIMENSIONS ARE IN INCHES. METRIC DIMENSIONS WILL BE WITHIN [XX]		CHECKED BY	DATE					
		APPROVED BY	DATE	SCALE	SHEET	PART NO.	DRAWING NO.	REV.
					1 OF 1		SA1642	